



3 cabins 2 heads version:



3 cabins 3 heads - Skipper's cabin version:



GENERAL SPECIFICATIONS

• Overall Length (L.O.A)	17,12 m	56'2"
• Hull length	15,98 m	52'5"
• L.W.L.	15,40 m	50'6"
• Hull Beam	5,00 m	16'5"
• Standard draft (T-keel)	2,50 m	8'2"
• Standard ballast weight (Cast iron)	4 500 kg	9,918 lbs
• Shallow draft	1,95 m	6'5"
• Shallow ballast weight	5 100 kg	11,240 lbs
• Performance draft (T-keel)	3,02 m	9'11"
• Ballast weight performance (Cast iron/Lead)	4 510 kg	9,940 lbs
• Air draft (excluding antennae)	25,88 m	85'
• Performance air draft (excluding antennae)	26,88 m	88'
• Light displacement	15 599 kg	34,380 lbs
• Fuel tank capacity (standard)	400 L	106 US Gal
• Fresh water capacity (standard)	720 L	190 US Gal
• Engine power:		
- Sail drive (standard)	80 HP	80 HP
- Propeller shaft (Option)	110 HP	110 HP

ARCHITECTS / DESIGNERS

- Naval Architect: BISCONTINI YACHT DESIGN
- Outside & interior design: LORENZO ARGENTO

EC CERTIFICATION

- Category A - 10 people
- Category B - 12 people
- Category C - 14 people

STANDARD SAILS DIMENSIONS

ALUMINUM CLASSICAL MAST

• Mainsail	87,50 m ²	942 sq/ft
• Furling genoa (105 %)	73,36 m ²	790 sq/ft
• Code 0	162 m ²	1,744 sq/ft
• Asymmetrical spinnaker	254,00 m ²	2,730 sq/ft
• I	21,95 m	72'
• J	6,40 m	21'
• P	22,00 m	72'2"
• E	6,80 m	22'4"

CLASSIC MAST CARBON (+ 1 m / 3'3")

• Performance version mainsail	89,50 m ²	963 sq/ft
• Furling genoa (105 %)	76,90 m ²	828 sq/ft
• Code 0	160 m ²	1,722 sq/ft
• Asymmetrical spinnaker	265,00 m ²	2,850 sq/ft
• I	22,90 m	75'2"
• J	6,40 m	21'
• P	23,00 m	75'6"
• E	6,80 m	22'4"

seanapps

CONNECT YOUR BOAT FREE YOUR MIND

STANDARD EQUIPMENT

CONSTRUCTION

- Design made following European Directive requirements and according to CE certification
- ISO 12215 certified structure
- Balsa sandwich infused hull
- Vacuum infused structural inner liner (Fabric - resin) bonded to the hull
- Deck in glass fiber/balsa wood sandwich infusion, with non-slip "diamond point" surface
- Cast iron keel attached with bolts and bonded stainless steel backplate
- Twin rudders affixed with stainless steel stock
- White hull - Aluminum grey hull decoration
- 8 Hull portlights

DECK EQUIPMENT

RIGGING

- Depending on version:
 - **Black lacquered aluminum classical mast** tapered, deck stepped
 - 3 Aft swept spreaders
 - C-strand Rigging
 - C-strand backstay crowfoot with manual hydraulic piston to starboard (hydraulic unit optional)
 - Harken fixed blocks at foot of mast
 - Harken Switch mainsail track (without traveller)
 - **Performance carbon classical mast** tapered, deck-stepped (+ 1 m / 3'3", Weight saving: 100 kg / 220 lbs)
 - 3 Aft swept spreaders
 - ROD Rigging
 - Textile backstay crow's foot with manual hydraulic piston to starboard
 - Harken fixed blocks at foot of mast
 - Harken Switch mainsail track (without traveller)
- Lacquered aluminum Racing boom with LED lighting (warm white)
- Black Racing lacquered aluminum rigid boom vang with Dyneema tackle and friction rings (hydraulic available as an option)
- Genoa track on the cabin top with traveller and hauling line controlled from the cockpit
- Manual Genoa furler below deck
- 1 mainsail attachment point at bottom of cockpit with 1 stand-up block
- German system (Two-way mainsheet at the helm station)
- All lines lead back to the helm stations (except boom topping lift)
- Dyneema Complete running rigging:
 - Mainsheet halyard sheave block
 - Genoa halyard
 - Boom uphaul (polyester) with cleat on mast
 - Mainsheet
 - 2 Genoa sheets
 - 2 Automatic reefing system lines
- 7 halyard clutches to port, 4 to starboard
- HARKEN Black Magic blocks
- 2 Spinnaker sheet chain plates/code 0
- Running rigging hidden
- 2 Flag halyards

WINCHES

- 1 Manual self-tailing winch to starboard (H50.2 STP)
- 1 Electric self-tailing winch to port (H50.2 STPE)
- 2 Manual Genoa winches (H70.2 STP)
- 2 Aluminum Speed Grip winch handles
- Stowage of which handles in dedicated space in rope bags

SAILS

- Boast supplied without sails

MOORING - ANCHORING GEAR

- Polyester bowsprit with integrated anchoring gear and bobstay with spinnaker chainplate (for Code 0 and asymmetric spinnaker)
- Self-draining chain locker, Clench bolt, Piston-driven cover
- Single roller stainless steel bow fitting
- 12 V - 1 500 W vertical electric windlass - Remote control in mooring locker
- 6 Black anodized aluminum mooring cleats (Length: 0,40 m / 1'4")
- Stainless steel chafing plate

SAIL LOCKER

Access through T70 deck hatch, Passage width: 0,65 x 0,65 m / 2'2" x 2'2"

- Stainless steel ladder
- Shelving and stowage trays
- LED lighting
- 1 115 V Power outlet

SAFETY ON DECK

- 1 Black lacquered stainless steel open pulpit
- 2 Black lacquered stainless steel aft pulpits with integrated fairlead
- 1 Black lacquered stainless steel central aft pulpit (Height: 960 mm / 3'2")
- 2 Black lacquered stainless steel handrails on the coach roof
- 1 Lifebuoy support bracket on aft pulpit
- Wooden flagstaff (1 m/3'3") with integrated support on deck
- Dual textile lifelines and black lacquered stainless steel stanchions (Height: 620 mm / 2') - Side boarding gate on either side
- Emergency ladder on pushpit

COCKPIT

- Self-bailing cockpit
- Iro-Deck slatted
- 2 Sail lockers below cockpit seating
- 2 Stowage lockers behind the cockpit with stainless steel support for the fenders (650 x 390 mm / 2'2" x 1'3")
- 1 Access hatch to tender garage
- 1 Integrated housing in catwalks for diesel tank access and shore power socket
- 3 access points to water tanks at the forward end of the coach roof on the catwalks
- 1 Gas locker on forward deck next to anchor chain locker, space for 2 bottles
- Iro-Deck slatted on companionway sunbeds
- Iro-Deck slatted cockpit benches
- Iro-Deck slatted side helmsman's seat
- Foldaway helmsman foot chock
- 2 Removable footrests at the rear of the helm station
- 2 Steering wheel consoles:
 - Black composite helm (diameter 1 100 mm/3'7") fixed on white lacquered aluminum pedestal
 - Steering gear at the helm station
 - Stainless steel steering chain transmission system
 - Black lacquered stainless steel hand rail
- 1 Emergency tiller
- 1 Steering compass on port console
- Engine throttle and control panel on starboard
- 1 Cockpit shower with mixer tap in the tender garage
- 1 PPMA folding companionway door in the bottom of the cockpit - Sliding hatch made of PMMA
- Lifteraft locker in front of the companionway (Space for 12 person liferaft: 0,96 m x 0,59 m x 0,40 m / 3'2" x 1'11" x 1'4")
- Courtesy lighting (7 LED lighting points, warm white lighting)

SWIM PLATFORM / AFT TRANSOM

- Fully opening transom, convertible into swim platform (2,61 m x 0,93 m / 8'7" x 3'1")
- 3 Folding access steps to the cockpit to starboard
- Electrically controlled opening on console
- Iro-Deck slatted swim deck
- 1 Stainless steel, removable bathing ladder with dedicated stowage in the cockpit

TENDER GARAGE

Accessible from the platform and from the cockpit
Can be used to house a Highfield UL240 type tender (2,48 m x 1,69 m x 0,80 m / 8'2" x 5'7" x 2'7")

- 1 Touch-operated ceiling LEDs

INTERIOR

- Alpi teak woodwork and white lacquered wood on base units and bulkheads
- Alpikord teak flooring
- Lounge Falcon 162 fabric interior upholstery
- Mattresses in the cabins (HR foam 35 kg/m³, thickness 120 mm/5")
- Beige padded ceilings (and Macadamia in the central part of the salon)

Standard version: 3 cabins + 2 heads



COMPANIONWAY

Headroom: 2,00 m / 6'7"

- Salon companionway with 5 suspended Alpikord teak non-slip steps, LED lighting below each step
- 2 Leather-covered stainless steel handrails (DK02 - chocolat color)

SALON

Headroom: 2,00 - 1,97 m / 6'7" / 6'6"

Starboard salon:

- Very comfortable Lounge type L-shaped sofa:
 - seats with HR26 and HR30 foam
 - softness thanks to the finish with hollow fibres + padding
- Coffee table, wooden top with molded fiddles, access to bottle rack opposite the seat
- Storage under bench seats
- 1 Electrical panel to starboard incorporated into a piece of furniture for access to electrical connections
- 2 Portholes with integrated blinds
- 2 Coachroof windows including opening porthole with mosquito screens
- 2 Opening deck hatches with mosquito screens/blinds
- Indirect LED lighting below and above the portholes
- 1 Adjustable reading light
- 1 dual USB port
- 1 115 V Power outlet
- Audio:
 - Fusion RA210 entertainment system
 - 2 Interior speakers
 - 2 Waterproof exterior speakers

Port salon:

- Wooden table with integrated sliding extension leaf
- Face-to-face bench seats with extension (can seat up to 6 guests)
- 2 Portholes with integrated blinds
- Storage under bench seats
- 1 Deep storage unit against bulkhead + 1 Glove box (unless air conditioning option chosen)
- Indirect LED lighting on the upper part of the portholes
- 1 115 V Power outlet close to forward bulkhead
- Pillar with beige cover

GALLEY - PORTSIDE

Headroom: 2,01 m / 6'7"

- C-shaped galley
- Corian Glacier White work top with moulded Apli teak beading
- 1 1 rectangular stainless steel sink - 1 Faucet with hot/cold water under pressure
- 1 Gas stove 3 burners - Stainless steel/grill fitted on swivel joints (19 L) - Stainless steel protection handrail - Stowage below the oven with drop-down door - Tempered glass cover on the hotplate
- 1 Stowage on counter top with top opening (Space for optional 36 L stainless steel cool box)
- 1 3 drawer storage on the work top (Space for the dishwasher option)
- 12 V 174 L fridge with integrated 16 L freezer (-18 °C), 1 Front opening door
- Fitted cupboards and closed cubbyholes
- 1 Garbage bin (20 L)
- 1 Base unit: 1 drawer on the side, 2 doors, 1 shelf
- 2 Opening portholes with mosquito nets

OWNER'S CABIN

Headroom: 2,01 - 1,96 m / 6'7" - 6'5"

- Central double bed (2,00 m x 1,60 m - 1,15 m / 6'9" x 5'3" - 3'9") with Lounge Greige 160 fabric padded headboard
- 1 Bed access sideboard
- 1 Seat on each side of bed with Lounge Falcon 162 fabric
- 2 Shoe stowage beneath the bed
- 2 Hanging lockers, with incorporated LED lighting
- 1 Central full-height unit with LED lighting: 4 drawers at the bottom, 1 door with 4 shelves, mirror inside the door
- 2 Night tables
- 2 Flexible and adjustable bedside lamps
- 1 T70 flush deck hatch with blind/mosquito net
- 2 Portholes with rigid sliding blinds
- 1 115 V power socket on each side of the bed
- 1 dual USB port outlet on each side of the bed
- LED indirect lighting + Spot lighting

2 PRIVATE HEADS

to starboard:

Headroom: 1,92 m / 6'4"

- 1 Manual marine toilet
- 1 80 L / 13 US Gal Rigid holding tank
- Counter-top in Corian Glacier White
- 1 Integrated polyester basin - Mixer tap
- 1 Cabinet - Mirror
- Toilet accessories
- 1 Deck hatch with mosquito screen/blind
- LED indirect lighting + Spot lighting

to port:

Headroom: 1,97 m / 6'6"

- Shower with seat and wooden shower base
- 2 Open stowage trays
- 1 Deck hatch with mosquito screen/blind
- LED indirect lighting

PORT AFT CABIN

Headroom: 1,92 m / 6'4"

- 1 Double bed (2,04 m x 1,40 m / 6'8" x 4'7")
- 1 Hanging locker, 1 Cupboard with shelves, with incorporated LED lighting
- 2 Lockers with top opening along the hull
- 1 Bed access sideboard
- 1 Drawer under the bed
- 1 Large storage under the bed, top opening (location for air conditioning option)
- 1 Flexible, swivelling reading light at headboard
- 1 Flexible and adjustable reading light on the hanging locker
- 1 dual USB port
- 1 115 V Power outlet
- 1 Porthole with rigid sliding blind
- 1 Opening window with below cockpit seat with pleated blind
- 2 Opening windows on coaming with pleated blind (1 with the 3 heads version)

STARBOARD AFT CABIN

Headroom: 1,92 m / 6'4"

- 1 Double bed (2,04 m x 1,40 m / 6'8" x 4'7")
- 1 Hanging locker, 2 lockers with top opening along the hull
- 1 Bed access sideboard
- 1 Drawer under the bed
- 1 Large storage under the bed, top opening (location for air conditioning option)
- 1 Flexible, swivelling reading light at headboard
- 1 Flexible and adjustable reading light on the hanging locker
- 1 USB socket
- 1 115 V Power outlet
- 1 Porthole with rigid sliding blind
- 2 Opening windows with below cockpit seat with pleated blind
- 1 Opening window on coaming with pleated blind

AFT STARBOARD HEAD COMPARTMENT

Headroom: 1,95 m / 6'5"

Access from the salon or the starboard aft cabin

- Separate shower - 1 Mixer tap - White polyester shower base
- Corian Glacier White counter-top with self-draining storage
- 1 Manual marine toilet
- 1 80 L / 21 US Gal Rigid holding tank
- 1 Washbasin - 1 Mixer tap
- 1 Cabinet + Storage space under the basin
- 2 Mirrors
- Toilet accessories
- 1 Opening porthole on coaming in side window, opaque film, mosquito screen

3 cabins 3 heads version (Option)

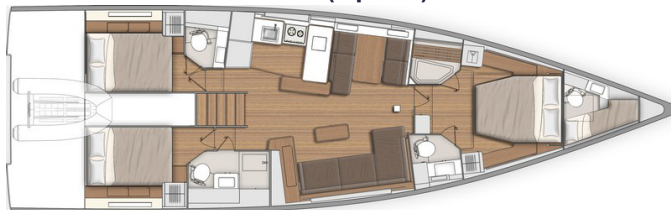

This head stands between the galley and the after port cabin: single hanging locker and one opening porthole in the aft cabin

AFT PORT HEAD COMPARTMENT

Headroom: 2,03 m / 6'8"

Access by the aft starboard cabin

- Polyester counter top with integrated basin - 1 Mixer tap - 1 Shower - White polyester shower base
- 1 Quiet Flush electric WC, fresh water or seawater
- 1 50 L / 13 US Gal Rigid holding tank
- 1 Bathroom cabinet 2 doors
- 1 Mirror above the washbasin
- Toilet accessories
- 1 Opening porthole on coaming in side window, opaque film, mosquito screen
- 1 Fixed window on coaming, opaque film

ENGINE

- Engine Yanmar Diesel:
 - 80 CV/HP, Sail Drive, Common Rail (standard)
 - 110 CV/HP, Propeller shaft, Common Rail (Option)
- Engine control at the starboard helm station - Control panel
- Engine compartment:
 - Soundproofing foam
 - Ventilation: 2 air intakes and 1 forced air outlets
 - Automatic LED lighting
- Engine data visible on the B&G screen
- 1 Alternator (12 V / 125 Amp)
- 2 Rotomolded diesel tanks 2 x 200 L / 2 x 53 US Gal (under aft berth port and starboard) - Electronic gauge - Low level alarm - 1 Tank filling access
- Filters: Sea water - Diesel - Water separator
- Foldaway three-blade propeller
- 1 Engine access through companionway (opening with 2 gas pistons)
- 2 Engine access through aft cabins

PLUMBING

- 1 Rotomolded freshwater tank 380 L / 100 US Gal, under berth in forward cabin - 1 Tank filling access
- 2 Rotomolded freshwater tanks 2 x 150 L / 2 x 40 US Gal, under salon floor, port and starboard - 1 Tank filling access
- Waterpressure system - Expansion tank - Inline filter
- 40 L / 11 US Gal Electric water heater (engine use)
- 1 Rigid black water holding tank for each WC
- Electrical shower drain pumps
- 1 Electric bilge pump
- 1 Manual bilge pump
- Transfer valves easily accessible from the companionway

GAS

- 1 Compartment for 2 gas bottles in the anchor locker (diameter: 0,28 m / 11" x Height: 0,45 m / 1'6")
- Regulator and solenoid
- Gas leak detector

SMART BOARD

"SEANAPPS" smart technology:

- For monitoring the boat's status and receiving alerts as well as maintenance advice via the associated mobile application.
- The type of information collected (GPS position, batteries, engine info, navigation data, etc.) varies according to the boat's configuration.



ELECTRICITY

- 12 V electrical panel (Breaker, Voltmeter, Water gauge, Fuel gauge, Battery warning, Fuel warning, Water warning) + dual USB port + Navicolor 3.5" screen
- Radio controlled wireless light switches (no battery) for lighting (excluding heads)
- 10 touchscreen table on the electrical panel, dedicated to Ship Control, allowing all functions to be managed from the salon
- **Ship Control technology** control numerous functions from the navigation screens (or from a tablet or smartphone using a dedicated app):
 - Anchoring and masthead navigation lights
 - Boom and spreader lights (optional), underwater spotlights (optional)
 - Courtesy light in cockpit
 - Direct lighting
 - Deck searchlight
 - Inverter (Option)
 - Fridge
 - Water unit
 - Bilge pumps
 - Air conditioning (Option)
 - Generator (Option)
 - Audio
 - Control of levels (diesel, fresh water, black water)
 - Battery monitoring
- 12 V Circuit
- 3 AGM service batteries (140 Amp)
- 1 AGM engine battery (100 Amp)
- Battery cut-off switch easily accessible from the companionway
- 1 Battery charger (25 Amp)
- 1 Battery charger (40 Amp)
- 1 Pre-fitting for charger
- 1 Load balancer
- 11 115V Sockets:
 - 2 in the forward cabin
 - 1 in the forward port head
 - 1 in the aft cabins
 - 1 in the salon (starboard)
 - 1 at chart table
 - 2 in galley
 - 1 in the engine compartment
 - 1 in the sail locker
- 6 Dual USB socket:
 - 2 in the forward cabin
 - 1 in the aft cabins
 - 1 on the electrical panel
 - 1 at chart table
- 1 Shore power socket 115 V
- LED lighting:
 - Overhead lights, with dimmer
 - Reading lights
 - Indirect light, with dimmer
- LED navigation lights:
 - 1 Masthead light
 - 1 Steaming light
 - 1 Mooring light on masthead
- Deck searchlight (Halogen)
- Wire runs for optional cables

MISCELLANEOUS ITEMS

- Smoke detector
- Cleaning kit: eco-friendly cleaning products kit

TRIM LEVEL & PACKS

TRIM LEVEL

	COMFORT	LUXE
<ul style="list-style-type: none"> Coastal Pack (GARMIN) 1 Harken Performa H50.2 STPEH starboard electric maneuvering winch (instead of standard) Windlass control with chain counter in cockpit Opening transom remote control Retractable bow thruster + 4 Dedicated batteries (50 Amperes - 12 V) + 1 Battery charger (30 Amperes - 24 V) TECMA electric fresh water/sea water WC in the owner's head IBS sensor 2 Additional 140 ampères service batteries Additional 40 ampères battery charger Electrical engine control on the starboard console Mosquito nets for opening portholes 	<ul style="list-style-type: none"> ■ ■ ■ ■ ■ ■ ■ ■ ■ ■ 	<ul style="list-style-type: none"> ■ ■ ■ ■ ■ ■ ■ ■ ■ ■
<ul style="list-style-type: none"> Offshore Pack (GARMIN) 2 Solid wood cockpit tables with additional leaves (2 on the sides, 1 in the centre) on stainless steel pedestal and Charcoal Grey cover Outside cockpit upholstery, Dolce 51 seats and backrests (terrycloth), Filter foam 80 mm/3" thickness (Density: 60F + 20S) Spring mattress in the owner's cabin (thickness: 180 mm / 7") Quiet Flush fresh water/seawater electric WC in the aft starboard head 		<ul style="list-style-type: none"> ■ ■ ■ ■ ■

ELECTRONICS PACKS: GARMIN

	COASTAL (included in the Comfort trim level)	OFFSHORE (included in the Luxe trim level)
<ul style="list-style-type: none"> Port and starboard helm stations: <ul style="list-style-type: none"> 1 12" GPS Map 1223 multi-function touchscreen (GPS, Chart plotter, Card reader - Bluechart G3 cartography included) Wind Sensor gWind Race - pole 1m / 3'3": Windvane, Anemometer Airmar DST810 Sensor (Log, Speedometer, Temperature) PC interface (GND10) 315i VHF radio fixed to the chart table, without AIS receiver function Windex Windvane Protective covers for helm & consoles (Charcoal Grey) 	<ul style="list-style-type: none"> ■ ■ ■ ■ ■ ■ ■ 	<ul style="list-style-type: none"> ■ ■ ■ ■ ■ ■ ■
<ul style="list-style-type: none"> Reactor 40 Pilot with GHC 50 control on port console Wireless autopilot remote control GARMIN Quatix 7 connected watch 		<ul style="list-style-type: none"> ■ ■ ■

FASTNET PACK (implies pack Coastal or Offshore pack)

- 3 GNX120 7" mast screens + mast bracket + cover
- 800 AIS
- GHS11 VHF Wired handset at port helm station

RIGGING PACKS

MAINSAIL WINCH PACK (Compatible with the 2 masts)

- Self-tailing HARKEN Performa (H50.2 STPEH) electric winch on polyester pedestal in centre of cockpit
- Standard German System replaced by 1 Dyneema mainsheet

DOWNWIND PACK (Compatible with the 2 masts)

- 4 Additional halyard clutches to starboard
- 2 HARKEN Black Magic blocks for spinnaker sheet/code 0
- 1 HARKEN Black Magic block for spinnaker tackline with return on dedicated cleat in cockpit
- 1 Dyneema halyard with sheave block for spinnaker or Code 0
- 1 Dyneema halyard for spinnaker
- 1 Spinnaker tackline with return on dedicated cleat in cockpit
- Barber hauler (Chain plate on bulwark)

STAYSAIL RIGGING PACK (Compatible with the 2 masts - requires the self-tacking rigging pack)

- 1 Wichard double chainplate on forward deck for removable forestay
- 1 Dyneema halyard with sheave block for staysail

SELF-TACKING RIGGING PACK (Compatible with all masts and all rigging packs - implies pack Downwind)

- Self-tacking jib hardware (sheet only)
- 1 Self-tacking jib track with traveller

CARBON MAST SAILS PACK

- Full batten mainsail (91 m²/979 sq/ft) and Genoa (82 m²/882 sq/ft) North Sails NPL tour, dark grey
- Charcoal Grey lazy bag + lazy jack

ALUMINUM SAILS MAST PACK

- Full batten mainsail (87 m²/936 sq/ft) and Genoa (82 m²/882 sq/ft) North Sails NPL tour, dark grey
- Charcoal Grey lazy bag + lazy jack

MOORING PACK

- Delta 32 kg/71 lbs anchor (galvanized steel)
- Chain (diameter: 12 mm / $\frac{1}{2}$ " - Length: 40 m / 131')
- Line (diameter: 22 mm / $\frac{7}{8}$ " - Length: 50 m / 164')
- 6 Fenders:
 - 4 XL (diameter: 300 mm / 12" - Length: 880 mm / 2'11")
 - 2 L (diameter: 250 mm / 10" - Length: 700 mm / 2'4")
- 4 Moorings lines (diameter: 18 mm / $\frac{11}{16}$ " - Length: 15 m / 49'3")

MOORING PACK (inflatable)

- Delta 32 kg/71 lbs anchor (galvanized steel)
- Chain (diameter: 12 mm / $\frac{1}{2}$ " - Length: 40 m / 131')
- Line (diameter: 22 mm / $\frac{7}{8}$ " - Length: 50 m / 164')
- 6 Fenders (diameter: 360 mm / 1'2" - Length: 1 200 mm / 3'11")
- 4 Moorings lines (diameter: 18 mm / $\frac{11}{16}$ " - Length: 15 m / 49'3")

OPTIONS

NAVIGATION ELECTRONICS: GARMIN

- Chart table: 12" GPS Map 1223 multi-function touchscreen
- 800 AIS
- Panoptix PS51-TH (Forward underwater vision)
- Fantom 18x radar
- GHS 11 VHF Wired handset at port helm station

RIGGING - SAILS

- FurlerBoom V-shaped boom furler, black lacquered, epoxy fiberglass casing/carbon spindle. Integrated LED lighting for the cockpit area. For aluminium or carbon mast.
- Hydraulic unit (for carbon mast): Hydraulic textile backstay on piston + Hydraulic kicker tackle on unit (2 Functions / 2 speeds)
- Hydraulic unit (for aluminum mast): ROD rigging and hydraulic textile backstay on piston + Hydraulic kicker tackle on unit (2 Functions / 2 speeds)
- Electric Genoa furler below deck
- Aluminum black lacquered canoe boom with hydraulic piston, Sparcraft (Requires hydraulic unit option), Integrated LED lighting for the cockpit area
- Code 0 with North Sails NPL tour furler, laminated, dark grey (for aluminum mast)
- Code 0 with North Sails NPL tour furler, laminated, dark grey (for carbon mast)

WINCHES

- 2 Electric Harken Performa genoa sheet winches (H70.2 STPEH)

HULL - DECK - COCKPIT

- Pearl grey gel-coat (Hull & Bowsprit)
- Metallic hull paint (Hull - Aft transom - Bowsprit)
- Iro-Deck slatted side decks
- Iro-Deck slatted roof
- Retractable capstan (Bow)
- LED lighting of spreaders
- Retractable stern thruster
- Carbon or white composite helm
- Retractable NOMEN black anodized cleats (instead of standard)
- Accommodation ladder
- Outboard engine bracket
- Polyester folding gangway (2,60 m / 8'6")
- Electric inflator/deflator for tender and fenders (portable, battery-powered)
- Shore freshwater supply
- Seawater/fresh water deck washing pump
- 3 Underwater lights (1 forward, 2 aft)
- 1,20 m/3'11" carbon flagstaff (instead of standard)
- Tender launching system (Manual winch, 1 roller)
- 32 kg/71 lbs stainless steel anchor upgrade for anchoring pack
- Unpainted stainless steel lifelines and stanchions
- Solar panels on the coachroof (680 W)

COCKPIT COMFORT

- Sunbrella Loop Sand cockpit upholstery (requires Luxe trim level, as a replacement for the Dolce 51 upholstery)
- Electrical bases + mattress for the 2 cockpit tables (for the sun deck bed function) - Choice between: Sunbrella Loop Sand or Dolce 51, requires Luxe trim level

EXTERIOR GUARDS

- Sprayhood with LED lighting, Strataglass windows, Charcoal Grey
- Bimini Charcoal Grey (sprayhood option required)
- Bimini for helm stations, Charcoal Grey
- Sunshade for the cockpit, Charcoal Grey (compatible with all booms)
- Sunshade on foredeck, Charcoal Grey

INTERIOR EQUIPMENT

LAYOUT VERSIONS

- 3 cabins 2 heads version
- 3 cabins 3 heads version
- Skipper cabin replacing the sail locker of the foredeck: Access through T70 deck hatch, Stainless steel ladder, 1 Berth, WC, Sink, Shower, 1 dual USB port

AMBIANT

- Interior woodwork: Alpi oak 3 gloss + Alpikord oak floorings
- Internal upholstery according to color chart: Fabric, Leather, Nubuck, Ultra Leather

MULTIMEDIA

- TV pre-assembly on lifting system, in the salon
- TV pre-assembly, in the forward cabin (on bulkhead)
- APOLLO Stereo + Bose 2.1 speakers, in the salon (instead of standard)

DOMESTIC APPLIANCES

- Pre-fitting for dishwasher for 6 sets (115 V)
- Built-in 22 L broiler and microwave combined oven (115 V)
- Wine cellar 19 bottles (115 V)
- 36 L cool box with access from the galley counter top, stainless steel tank (temperature adjustable from +10 °C to -12 °C)
- 2 Stainless steel fridge drawers (2 x 95 L / 25 US Gal - 12-24 V/ 115 V) instead of standard (3 cabins 2 heads version)

ON BOARD COMFORT EQUIPMENT

- Spring mattress in the aft cabins (thickness: 160 mm / 6")
- Generator (7,5 KVA, 115 V, 60 Hz)
- Water maker (60 L/h / 16 US Gal/h)
- Air conditioning 44 000 BTU (+ Shore socket extension cord 15 m / 49'3") - 32 A
- Diesel heater "air pulse"
- Safe, in the forward cabin
- 12 V / 115 V inverter - 2 000 VA
- Electric battery switch (connected to the Ship Control, controls powering on or shut-off of batteries remotely)
- 3 Lithium batteries (150 Amperes) to replace the AGM batteries (requires Comfort trim level)
The lithium batteries can be used in exactly the same way as the greater number of AGM batteries that they replace. This technology allows 100% of the battery capacity to be used compared with 75% for the AGM batteries. The engine battery is still AGM.
- Sea water electric pump, in galley
- Lee cloth (Aft cabins & Salon sofa)
- Tableware Kit - 6 people